

NORTH

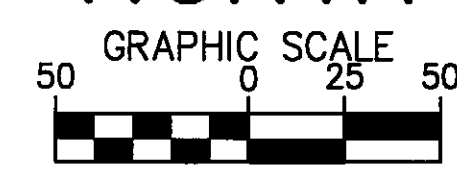

1 INCH = 50 FT.
(FULL SIZE DRAWINGS ONLY)

- NO DISTURBANCE RESTRICTION
- GREEN AREA RESTRICTION
- DRAINAGE EASEMENT

BENCHMARK:
U.S.G.S. BENCHMARK CML-67 1952
AT N.E. CORNER S.R. 18 BRIDGE
AT YELLOW CREEK
ELEVATION=1037.02

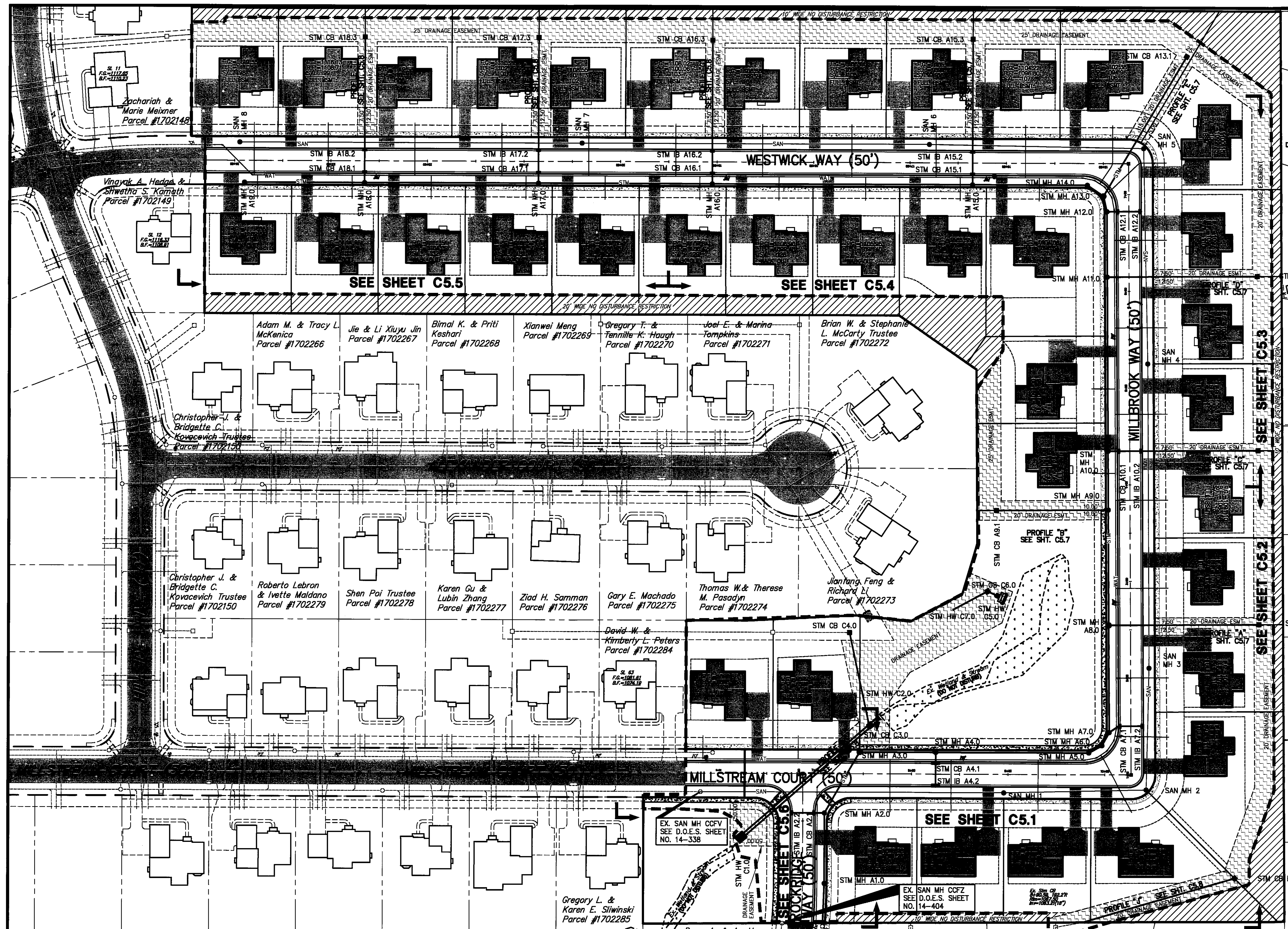

Lawrence and Roseann Pace Parcel #1700087
James and Billie Ruth Bagwell Parcel #1700006
Irene A. Zamadra Parcel #1700314
Jeffrey A. and Amy Franks Parcel #1700308
WESTMONT ESTATES NO. 2 P.B. 69 PG. 28 S.C.P.R.
Jared R. and Blaisea Werth Parcel #1700355
Gary Pressley Parcel #1700303
Stephanie D. Kenney Parcel #1700097
Lisa R. White and Vincent A. Rundo Parcel #1700187
Carlton O. Barnett and Athelin P. Barnett Parcel #1700245

JOB NO	12289F	SCALE	1"=50'
DRAWN BY	MJD	CHECKED BY	CJO
DWG NAME	12289C-plan	DATE	SEPTEMBER, 2014

HILLSIDE ESTATES - PHASE 4
SITE UTILITY PLAN
TOWNSHIP OF COPLEY, COUNTY OF SUMMIT, STATE OF OHIO

NEFF & ASSOCIATES
Civil Engineers • Landscape Architects • Planners • Surveyors
8405 York Road | Parma Heights, Ohio 44130
Tel: 440.884.3100 | Fax: 440.884.3104

REV NO	DATE	DESCRIPTION	BY
3	02/27/15	REV. PER COSE & SUMMIT SWCD	CJO
2	11/17/14	REV. PER COSE, DOES, AKRON WTR.	CJO
1	09/15/14	ORIGINAL SUBMITTAL	CJO

SHEET NO.
C4.0