

STORM WATER POLLUTION PREVENTION PLAN

CERTIFICATION

I, THE UNDERSIGNED, DO HEREBY CERTIFY UNDER PENALTY OF LAW THAT THIS DOCUMENT AND ALL ATTACHMENTS WERE PREPARED UNDER MY DIRECTION OR SUPERVISION IN ACCORDANCE WITH A SYSTEM DESIGNED TO ASSURE THAT QUALIFIED PERSONNEL PROPERLY GATHERED AND EVALUATED THE INFORMATION SUBMITTED. BASED ON MY INQUIRY OF THE PERSON OR PERSONS WHO MANAGE THE SYSTEM OR THOSE PERSONS DIRECTLY RESPONSIBLE FOR GATHERING THE INFORMATION, THE INFORMATION SUBMITTED IS, TO THE BEST OF MY KNOWLEDGE AND BELIEF, TRUE, ACCURATE, AND COMPLETE. I AM AWARE THAT THERE ARE SIGNIFICANT PENALTIES FOR SUBMITTING FALSE INFORMATION, INCLUDING THE POSSIBILITY OF FINE AND IMPRISONMENT FOR KNOWING VIOLATIONS.

JARONE HILLSIDE, LLC
 35700 EAST ROYALTON ROAD
 GRAFTON, OHIO 44044-9586
 PHONE: (440) 748-7483
 CONTACT: FRANK JARAM, PRESIDENT

OWNER/PERMITTEE SIGNATURE _____ DATE _____

DUTY TO INFORM CONTRACTORS AND SUBCONTRACTORS:

I, THE UNDERSIGNED, DO HEREBY ASSENT TO AND ACKNOWLEDGE HAVING REVIEWED AND UNDERSTAND THE TERMS AND CONDITIONS OF THIS STORM WATER POLLUTION PREVENTION PLAN AND THE TERMS AND CONDITIONS OF THE OHIO ENVIRONMENTAL PROTECTION AGENCY NPDES GENERAL PERMIT.

GENERAL CONTRACTOR _____

GENERAL CONTRACTOR CONTACT SIGNATURE _____ DATE _____

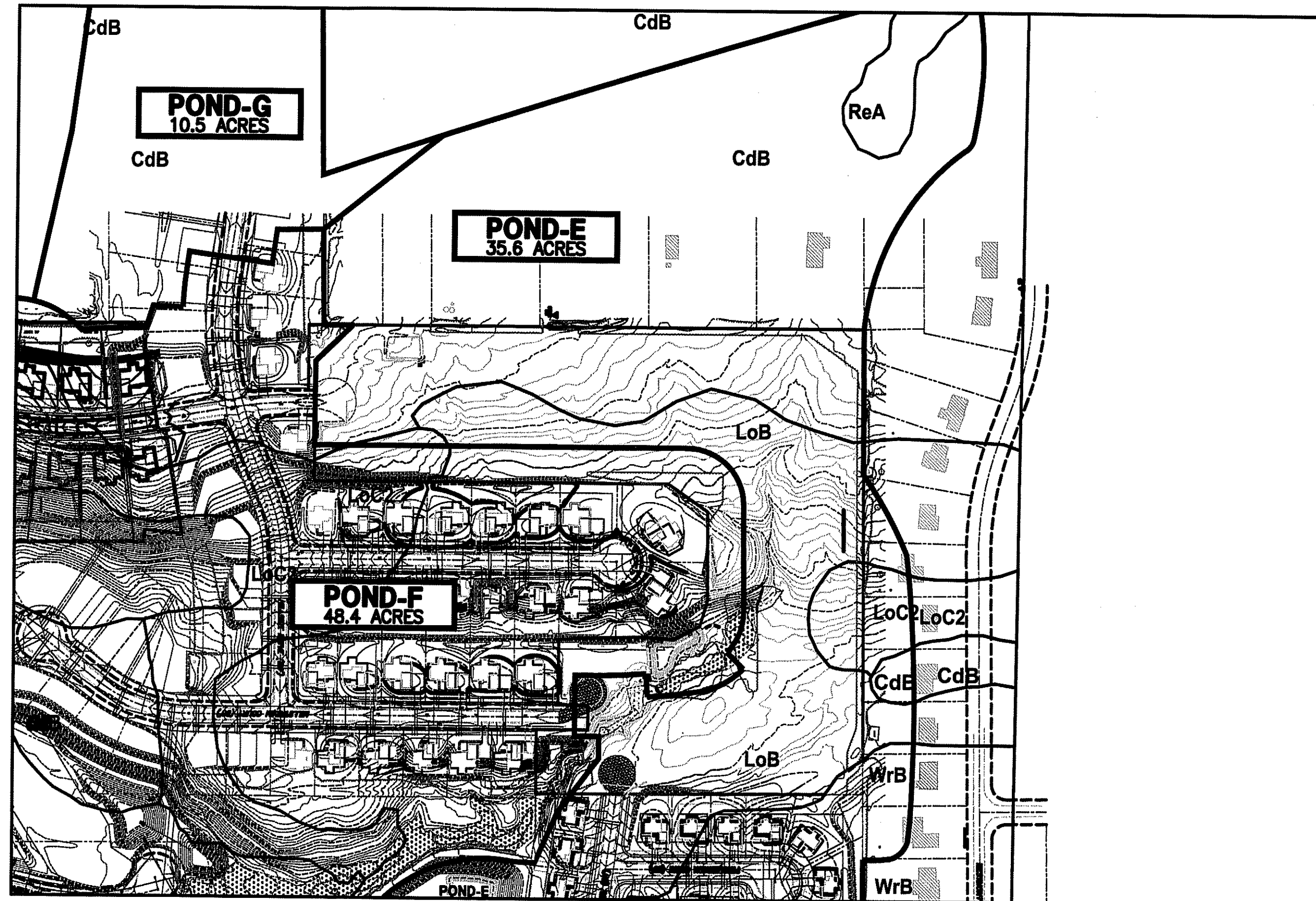

SWP3 OVERALL EXISTING SITE DRAINAGE MAP

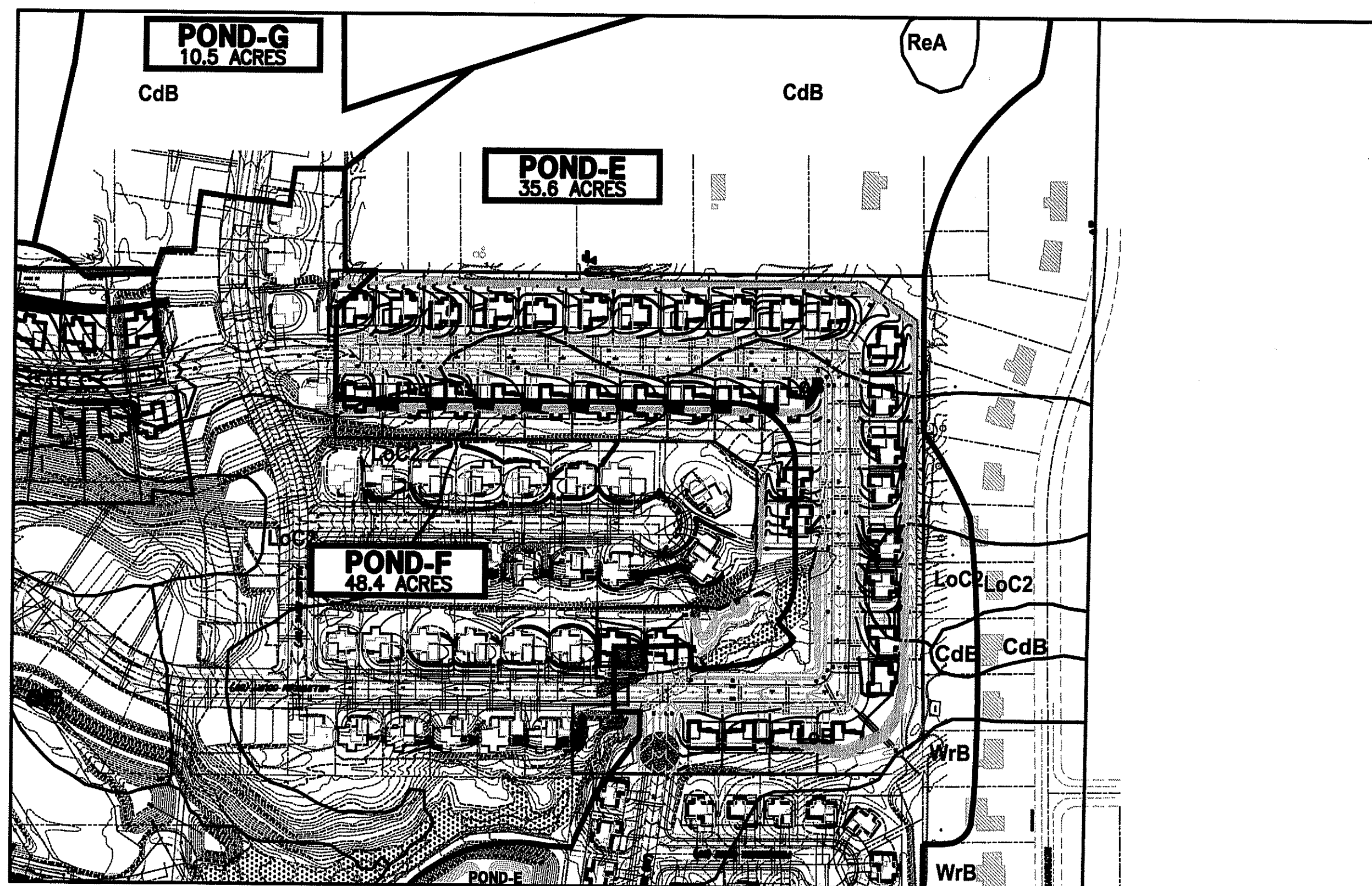

SWP3 OVERALL PROPOSED SITE DRAINAGE MAP

SOILS LEGEND:

- CdB - Canfield Silt Loam, 2-6% slopes
- LoB - Loudonville Silt Loam, 2-6% slopes
- LoC2 - Loudonville Silt Loam, 6-12% slopes
- WrB - Wheeling Silt Loam, 2-6% slopes

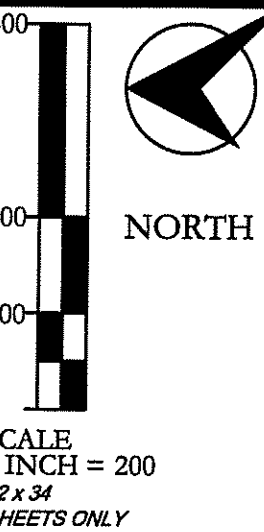

SWPPP AMENDMENT LOG

Amendment No	Description of the Amendment	Date of Amendment	Amendment Prepared by (Name & Title)

Instructions: Create a log above or as an attachment, of changes and updates to the SWPPP. You should include additions of new BMPs, replacement of failed BMPs, significant changes in the activities or their timing on the project, changes in personnel, changes in inspection and maintenance procedures, updates to site maps, and so on.

GRADING AND STABILIZATION ACTIVITIES LOG

Date Grading Activity Initiated	Description of Grading Activity	Date Grading Activity Ceased (Indicate Temporary or Permanent)	Date When Stabilization Measures Initiated	Description of Stabilization Measures and Location

Instructions: Create a log above or as an attachment, of grading and stabilization activities on the construction site.

NOTES:
 THE LOCATIONS OF ALL EROSION AND SEDIMENT CONTROL PRACTICES, INCLUDING IF APPLICABLE BUT NOT LIMITED TO THE LOCATION OF AREAS LIKELY TO REQUIRE TEMPORARY STABILIZATION, SEDIMENT AND STORM WATER MANAGEMENT BASINS, PERMANENT STORM WATER MANAGEMENT PRACTICES, AREAS DESIGNATED FOR STORAGE OF MATERIALS, THE LOCATION OF DESIGNATED CONSTRUCTION ENTRANCES, AND THE LOCATION OF ANY IN-STREAM ACTIVITIES CAN BE FOUND ON THE SHEETS CONTAINED WITHIN THIS STORM WATER POLLUTION PREVENTION PLAN.

OHIO
 Utilities Protection
 SERVICE
 Call Before You Dig
 1-800-362-2764
 CALL BEFORE YOU DIG
 Also call: OGPUPS @ 1-800-925-0988
 (Ohio Oil & Gas Underground Protection Service)

AUTHORITY FOR AUTHORIZING AND AMENDING THE SWP3

NEFF & ASSOCIATES
 6405 YORK ROAD
 PARMA HEIGHTS, OHIO 44130
 PHONE: (440) 884-3100
 FAX: (440) 884-3104
 CONTACT: DANIEL J. NEFF, P.E.

DANIEL J. NEFF - REGISTERED ENGINEER No. 50573 _____ DATE _____

JOB NO	12269F	SCALE	1"=200'
DRAWN BY	MJD	CHECK'D BY	CJO
DWG NAME	12269F-ds3p	DATE	SEPTEMBER, 2014

HILLSIDE ESTATES - PHASE 4
STORMWATER POLLUTION PREVENTION TITLE
 TOWNSHIP OF COPLEY, COUNTY OF SUMMIT, STATE OF OHIO

NEFF
 & ASSOCIATES
 Civil Engineers • Landscape Architects • Planners • Surveyors
 6405 York Road | Parma Heights, Ohio 44130
 Tel: 440.884.3100 | Fax: 440.884.3104
 www.neff-assoc.com

REV NO	DATE	DESCRIPTION	BY
1	09/15/14	ORIGINAL SUBMITTAL	CJO

SHEET NO.
C2.0