

WETLANDS (SEE C102)

TOTAL WETLANDS ON SITE = 0.60 Ac.
 WETLANDS TO BE FILLED = 0.35 Ac.
 WETLANDS TO REMAIN = 0.25 Ac.

USACE PERMIT NO. 2015-01091
 PREPARED BY:
 FLICKINGER WETLAND COMPANY, LLC
 8530 N. BOYLE PARKWAY
 TWINSBURG, OH 44087

SITE BENCH MARK

BENCH MARK #1
 TOP NUT ON HYDRANT
 IN CUL-DE-SAC ON ALLIANCE DRIVE
 ELEVATION = 911.93

SITE BENCH MARK

BENCH MARK #2
 TOP NUT ON HYDRANT
 ON DUNHAM ROAD
 ELEVATION = 952.66

ITALICS TEXT REPRESENTS EXISTING CONDITION
 NON-ITALICS TEXT REPRESENTS PROPOSED CONDITION



2555 Harville Rd., Suite B
 Rootstown, OH 44272
 www.WeberEngineeringServices.com
 330-329-2037
 matt@webercivil.com

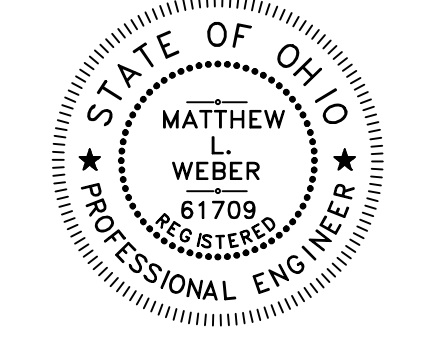

Reg. No.: 61709

Dunham Land Properties llc.

756 Ravenhill Drive
 Sagamore Hills, OH 44067
 Paul Karnow
 Ph.# (330) 468-2892
 Fax# (330) 468-2892

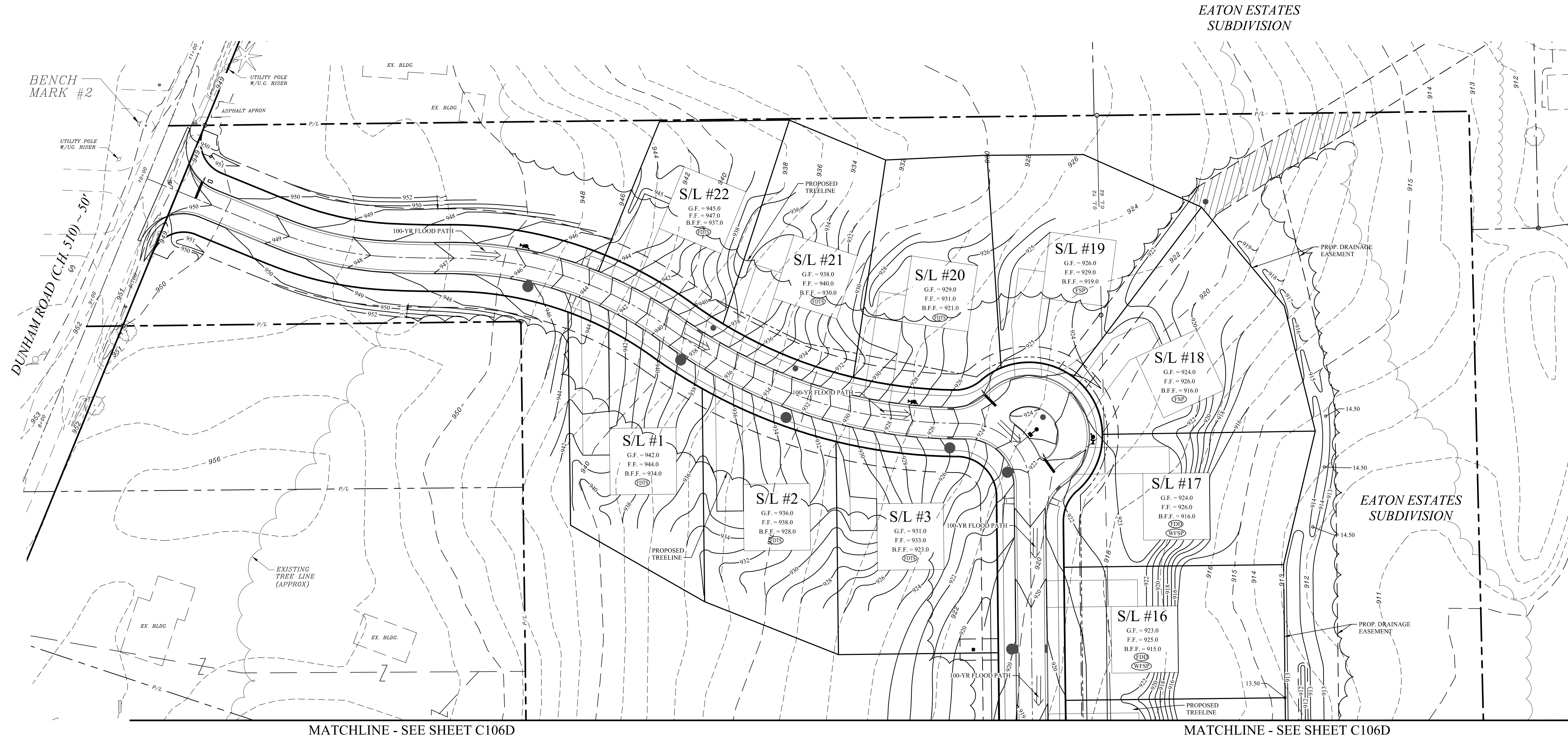

MATCHLINE - SEE SHEET C106D

MATCHLINE - SEE SHEET C106D

- FSP = FOUNDATION SUMP PUMP
- FDD = FOUNDATION DAYLIGHT DRAIN
- WFSP = WALK OUT FOUNDATION SUMP PUMP
- FDTS = FOUNDATION DRAIN TO STORM SEWER



Scale: 1" = 40'

OHIO
 Utilities Protection
 SERVICE
 Call Before You Dig
 800-362-2764 or 8-1-1
 www.oups.org



800-925-0988 or 8-1-1
 www.ogpups.org

HIDDEN RIDGE
 RESIDENTIAL SUBDIVISION
 DUNHAM ROAD

Issue Date
 01-25-2016
 02-05-2016
 02-11-2016
 02-25-2016
 06-01-2016
 06-29-2016
 08-10-2016
 09-08-2016
 10-03-2016
 10-10-2016
 03-27-2017

**FINAL
 GRADING
 PLAN**

C106C
 Project No. 2014-226