

- SWPP KEYNOTES**
- DS** DIVERSION SWALE
 - IME** INTERMEDIATE MASS EARTHWORK
 - IP** INLET PROTECTION
 - SF** SILT FENCE
 - ST** STRIP TOPSOIL
 - TS** TOPSOIL STOCKPILE
 - EDI** EXCAVATED DROP INLET
 - SD** TEMPORARY SEEDING

Underground Utilities

2 Working Days
 Before You Dig
 Call 800-362-2764 (Toll Free)
 Ohio Utilities Protection Service

Non-members
 Must Be Called Directly
 Call 800-925-0988 (Toll Free)
 Oil & Gas Producers Utility Protection Service

NOTE:
 ALL OIL AND GAS WELL REMOVALS, PLUGGING/CAPPING, AND ABANDONMENTS SHALL BE IN ACCORDANCE WITH ALL ASSOCIATED REGULATIONS FOR SUCH REMOVALS, INCLUDING BUT NOT LIMITED TO, ODNR, LOCAL, STATE, AND FEDERAL.

EXISTING HIGH PRESSURE GAS MAIN SHALL BE LOCATED AND PROTECTED PRIOR TO AND THROUGHOUT CONSTRUCTION.

SWPP SEQUENCE – STAGE 2B (SHEETS 14–16)

1. MAINTAIN SEDIMENT BASINS, DIVERSION SWALES AND SILT FENCE.
2. INSTALL SEDIMENT TRAP (CONTROL AREA GARNETT CIRCLE) SEDIMENT TRAP #1.
3. TOPSOIL STOCKPILE AT HARVESTER (SOUTH) TO BE PUSHED TOWARD WEST AT REAR LOTS OF DUXBURY DRIVE; SPOIL WITHIN BORROW AREAS.
4. PERFORM REMAINING MASS EARTHWORK, INCLUDING EXCAVATION AT GARNETT CIRCLE AND EMBANKMENT AT SOUTH END OF HARVESTER DRIVE. UTILIZE HAUL ROUTE (SHOWN) AND DESIGNATED POINT OF CROSSING OVER DEO GAS PIPELINE.
5. FINALIZE ALL INTERMEDIATE GRADING TO SUBGRADE.
6. INSTALL REMAINING PHASE 1 UTILITIES (BRATTON DRIVE AND DUXBURY DRIVE-SOUTH).
7. INSTALL ALL PHASE 1 REAR LOT DRAINAGE SYSTEMS.
8. RESPREAD 6" TOPSOIL AT ALL DISTURBED AREAS.
9. INSTALL TEMPORARY SEEDING AND MULCHING.
10. UPON 100% OF DISTURBED AREA HAVING 80% VEGETATIVE COVER, THE SITE SHALL BE CONSIDERED STABILIZED WITH VEGETATION. CONVERT SEDIMENT BASINS TO FINAL SWM DETENTION BASINS (SEE SHEETS 31 TO 34).
11. REMOVE TEMPORARY BMP'S PHASE 1 LIMITS ONLY; SWPP BMP'S WITHIN FUTURE PHASE AREAS TO REMAIN.

- LEGEND**
 (SEE GENERAL LEGEND, SHEET 4)
- EXISTING RIPARIAN SETBACK
 - PROPOSED SILT FENCE "ORANGE"
 - PROPOSED TREE PROTECTION
 - LIMITS OF DISTURBANCE
 - DIVERSION SWALE
 - LIMITS OF SOIL TYPE
 - W/B SOIL TYPE DESIGNATION
 - IP INLET PROTECTION
 - STAGE 2B HAUL ROUTE

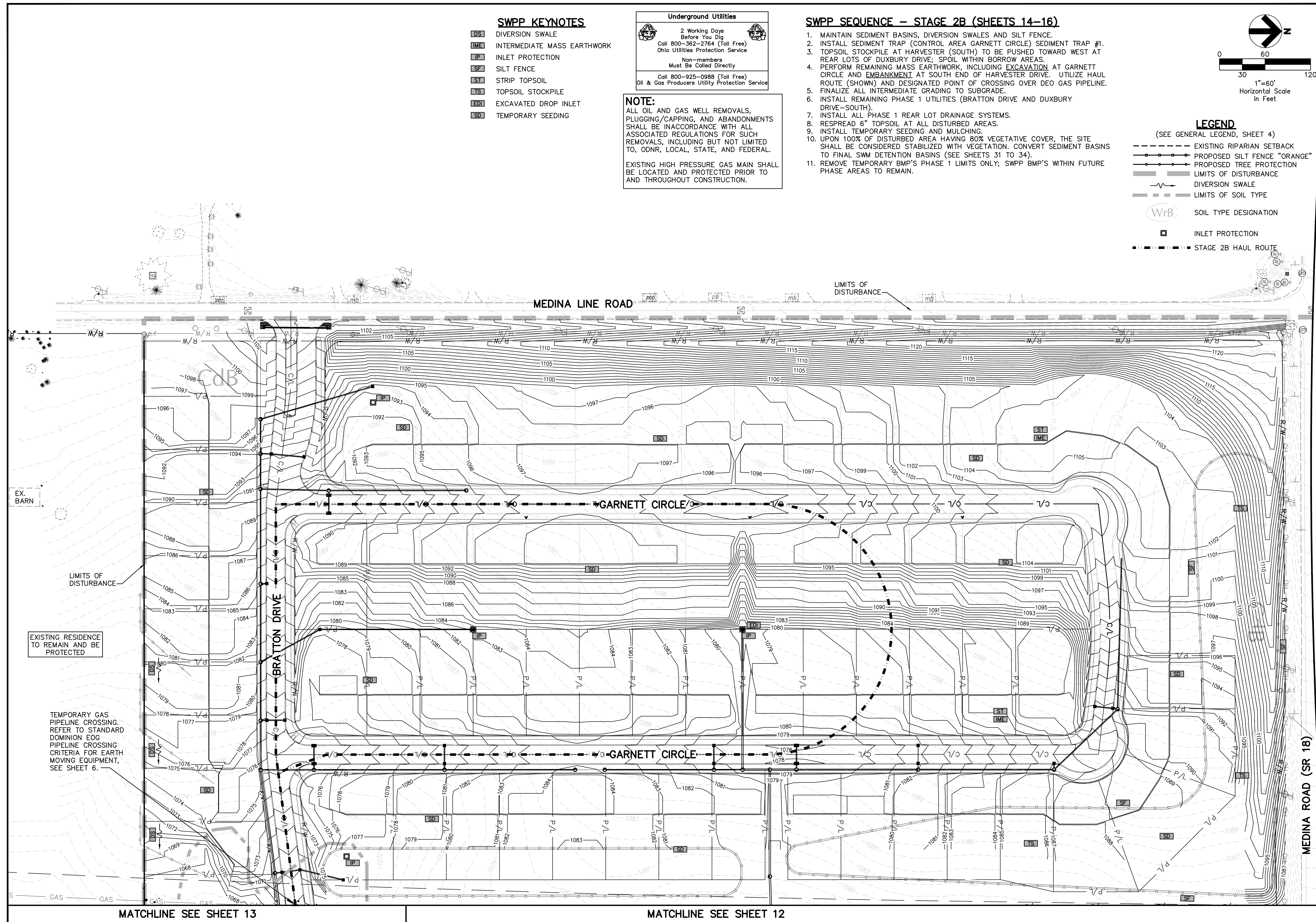

REV.	DATE	DESCRIPTION
1	06/02/14	REVISED PER LOCAL AGENCY COMMENTS
2	06/27/14	REVISED PER LOCAL AGENCY COMMENTS
3	07/18/14	REVISED PER LOCAL AGENCY COMMENTS
4	07/25/14	REVISED PER LOCAL AGENCY COMMENTS
5	08/01/14	MILLER PARCEL UTILITY UPDATE
6	08/05/14	COMMENTS FOR GRADING APPROVAL
7	08/20/14	REVISED PER LOCAL AGENCY COMMENTS
8	08/22/14	SANITARY REVISION MH 300-302
9	09/12/14	REVISED PER LOCAL AGENCY COMMENTS

THE PRESERVE AT MILLER'S FARM
 SE CORNER OF SR 18 AND MEDINA LINE RD
 COPLEY, OHIO 44321

**SWPP STAGE 2B
 INTERMEDIATE PLAN**

ISSUED FOR:	
PERMIT	06-02-14
BID	06-02-14
CONSTRUCTION	09-16-14
RECORD	-
PROJECT MANAGER	DESIGNER
MAL	KB

JOB NO.
2013258.00

14/81