

SWPP SEQUENCE – STAGE 2A (SHEETS 11-13)

1. MAINTAIN TREE AND WETLAND PROTECTION MEASURES AND PERIMETER SILT FENCE INSTALLED DURING SWPP STAGE 1.
2. STRIP TOPSOIL (ALL DISTURBED AREAS) AND STOCKPILE IN DESIGNATED LOCATIONS. INSTALL SILT FENCE AT PERIMETER OF ALL SOIL STOCKPILES.
3. INSTALL (4) SEDIMENT BASINS AS SHOWN. SEE SEDIMENT BASIN #1,2,3 AND 4. TEMP. DIVERSION SWALES SHALL BE IMPLEMENTED TO DIRECT ALL SITE RUNOFF INTO THE TEMP. SEDIMENT BASINS. PROVIDE TEMPORARY WATER TRAPS UNTIL FULL BASINS CAN BE INSTALLED.
4. INSTALL SANITARY SEWER (HARVESTER DRIVE – NORTH TO CREEKRUN DRIVE).
5. PERFORM MASS EARTHWORK, INCLUDING EXCAVATION AT SOUTH END OF DUXBURY DRIVE AND EMBANKMENT AT NORTH END OF HARVESTER DRIVE, CONCORD CIRCLE, AND DUXBURY DRIVE. ADDITIONAL EMBANKMENT SUBSOIL MATERIAL SHALL BE TRANSPORTED FROM WEST END OF GARNETT CIRCLE; HOWEVER SHALL BE LIMITED TO DESIGNATED POINTS OF CROSSING OVER THE DOMINION EOG HIGH PRESSURE TRANSMISSION PIPELINE. REFER TO THIS SHEET FOR LIMITED CROSSING LOCATIONS.
6. INSTALL PHASE 1 UTILITIES (HARVESTER DRIVE, DUXBURY DRIVE-NORTH, AND GARNETT CIRCLE-EAST).
7. REFER TO SWPP-STAGE 2B (SHEETS 14-16).

Underground Utilities

2 Working Days Before You Dig
 Call 800-362-2764 (Toll Free)
 Ohio Utilities Protection Service
 Non-members Must Be Called Directly

Call 800-925-0988 (Toll Free)
 Oil & Gas Producers Utility Protection Service

NOTE:
 ALL OIL AND GAS WELL REMOVALS, PLUGGING/CAPPING, AND ABANDONMENTS SHALL BE IN ACCORDANCE WITH ALL ASSOCIATED REGULATIONS FOR SUCH REMOVALS, INCLUDING BUT NOT LIMITED TO, ODNR, LOCAL, STATE, AND FEDERAL.

EXISTING HIGH PRESSURE GAS MAIN SHALL BE LOCATED AND PROTECTED PRIOR TO AND THROUGHOUT CONSTRUCTION.

- SWPP KEYNOTES**
- [CE] TEMPORARY CONSTRUCTION ENTRANCE
 - [CS] CONSTRUCTION STAGING AREA
 - [IME] INTERMEDIATE MASS EARTHWORK
 - [SF] SILT FENCE
 - [ST] STRIP TOPSOIL
 - [TS] TOPSOIL STOCKPILE
 - [SD] TEMPORARY SEEDING

CONSTRUCTION STAGING AREA:
 CONSTRUCTION STAGING AREA SHALL INCLUDE PROVISIONS FOR DUMPSTERS, TOXIC WASTE CONTAINERS, SANITARY FACILITIES, VEHICLE REFUELING, CONSTRUCTION LAYDOWN AREA, AND CONCRETE WASHOUT.

LEGEND
 (SEE GENERAL LEGEND, SHEET 4)

- EXISTING RIPARIAN SETBACK
- PROPOSED SILT FENCE "ORANGE"
- PROPOSED TREE PROTECTION
- LIMITS OF DISTURBANCE
- LIMITS OF SOIL TYPE
- Wrb SOIL TYPE DESIGNATION

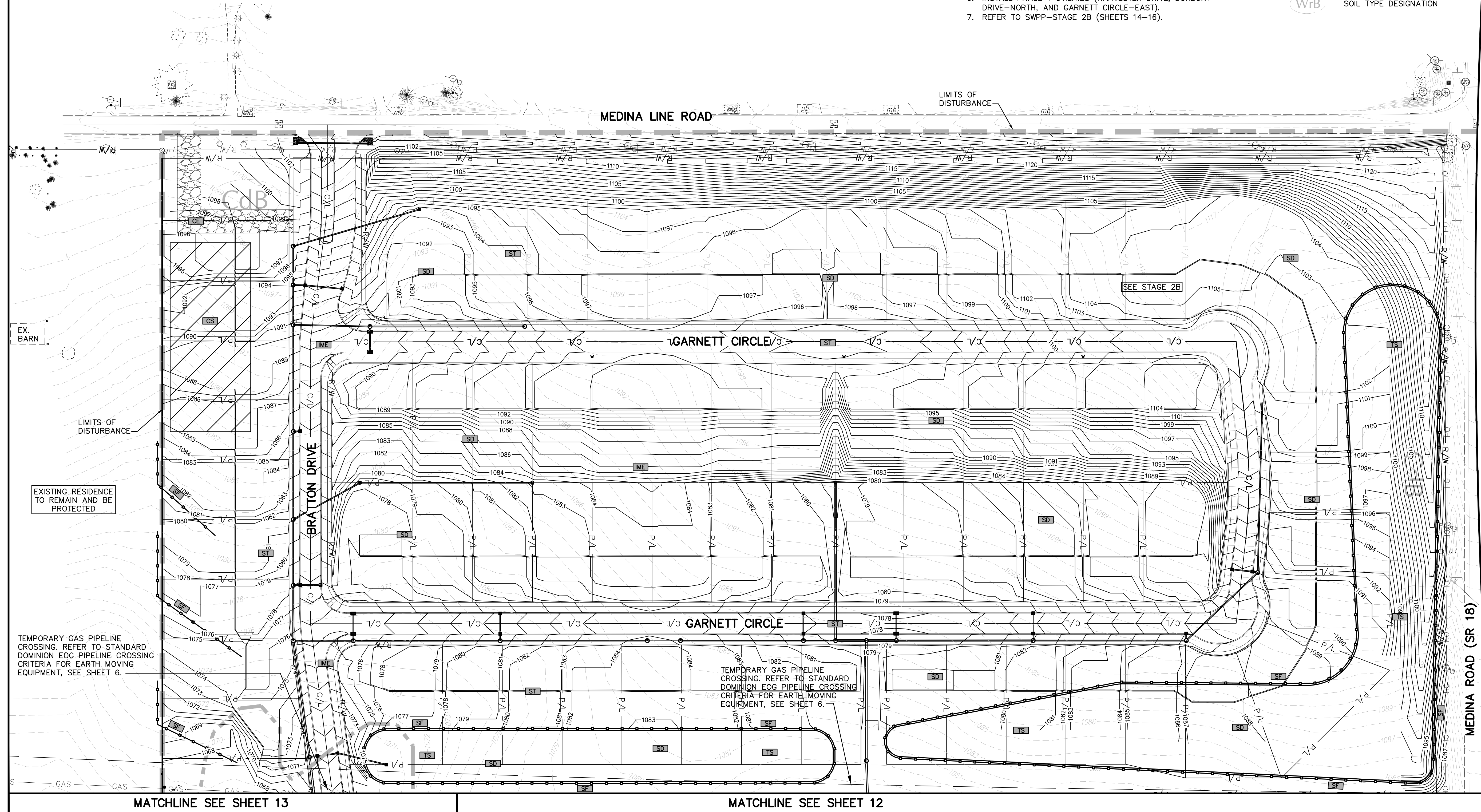

REV.	DATE	DESCRIPTION
1	06/02/14	REVISED PER LOCAL AGENCY COMMENTS
2	06/27/14	REVISED PER LOCAL AGENCY COMMENTS
3	07/18/14	REVISED PER LOCAL AGENCY COMMENTS
4	07/25/14	REVISED PER LOCAL AGENCY COMMENTS
5	08/01/14	MILLER PARCEL UTILITY UPDATE
6	08/05/14	COMMENTS FOR GRADING APPROVAL
7	08/20/14	REVISED PER LOCAL AGENCY COMMENTS
8	08/22/14	SANITARY REVISION MH 300-302
9	09/12/14	REVISED PER LOCAL AGENCY COMMENTS

THE PRESERVE AT MILLER'S FARM
 SE CORNER OF SR 18 AND MEDINA LINE RD
 COPLEY, OHIO 44321

SWPP STAGE 2A
INTERMEDIATE PLAN

ISSUED FOR:

PERMIT	06-02-14
BID	06-02-14
CONSTRUCTION	09-16-14
RECORD	-

PROJECT MANAGER	DESIGNER
MAL	KB

JOB NO.
2013258.00

11/81