

EXISTING STRUCTURE TABLE

ST-1 EX GRATE CURB INLET TOP 1014.46 INV. 12" CPP W 1010.61 INV. 12" CPP S 1010.61	ST-2 EX GRATE CURB INLET TOP 1004.52 INV. 12" CPP W 1005.67 INV. 12" CPP S 1004.91 INV. 18" CONC. E 1002.55 INV. 12" CONC. N 1004.60	ST-3 EX GRATE INLET TOP 1008.35 INV. 12" CPP SE 1004.20 INV. 12" CPP N 1002.49 INV. 18" CONC. E 1002.55 INV. 12" CONC. N 1004.60	ST-4 EX GRATE CURB INLET WINDOW 1008.36 INV. 12" CPP N 1005.13	ST-5 EX GRATE CURB INLET WINDOW 1008.82	ST-6 EX GRATE INLET TOP 1008.38 INV. 18" CONC. E 1000.13 INV. 18" CONC. W 1000.28	ST-7 STORM M.H. TOP 1010.24 INV. 24" CPP E 1007.41 INV. 24" CPP E 1004.58 INV. 12" CPP W 1009.36	ST-8 GRATED CURB INLET WINDOW 103.25 WINDOW 103.25 ST-4 GRATED CURB INLET WINDOW 103.25 WINDOW 103.25	ST-9 EX GRATE INLET TOP 1028.10 INV. 12" CPP E 4 W 1016.32	ST-10 EX GRATE INLET TOP 1011.43 INV. 12" CPP W 1004.23 INV. 12" CPP N 1004.23 INV. 48" CMP S 1004.33	ST-11 EX GRATE INLET TOP 1018.42 INV. 12" CPP E 4 W 1016.32	ST-12 EX GRATE INLET TOP 1011.43 INV. 12" CPP W 1004.23 INV. 12" CPP N 1004.23 INV. 48" CMP S 1004.33	ST-13 STORM M.H. TOP 1009.18 INV. 12" CPP E 1003.30 INV. 12" CPP S 1003.50	SA-1 SAN. M.H. TOP 1010.24 INV. 8" VIT S 984.24 INV. 8" VIT N 984.25 INV. 6" PVC W 984.79 INV. 6" PVC E 984.18 INV. 6" PVC N 1003.18 (INSIDE DROP)	SA-2 SAN. M.H. TOP 1014.18 INV. 8" VIT S 1001.13 INV. 8" VIT N 1001.03	SA-3 SAN. M.H. TOP 1009.80 INV. 8" VIT S 986.80 INV. 8" VIT N 986.85	SA-4 SAN. M.H. TOP 1028.16 INV. 6" PVC E 1018.66 INV. 6" PVC W 1018.76 INV. 6" PVC E 1018.76	SA-5 SAN. M.H. TOP 1016.48 INV. 6" PVC W 1010.38 INV. 6" PVC E 1010.18
---	---	---	--	--	--	--	--	--	---	---	---	---	---	---	---	--	---

PROPOSED STRUCTURE TABLE

ST-1, 4" STORM MANHOLE (ODOT NO. 3) RIM: 1021.54 18" (N) INV. 1009.07 21" (NE) INV. 1008.82	ST-2, 4" STORM MANHOLE (ODOT NO. 3) RIM: 1021.44 18" (N) INV. 1013.72 18" (E) INV. 1012.10 4" (NE) INV. 1024.10	CB-5, ODOT 2-3 CATCH BASIN RIM: 1021.54 12" (N) INV. 1020.48 12" (E) INV. 1020.48 4" (NE) INV. 1025.51	CB-6, ODOT 2-3 CATCH BASIN RIM: 1024.10 12" (S) INV. 1021.70 8" (NE) INV. 1021.70 (FTS, DRAIN)	CB-7, ODOT 2-3 CATCH BASIN RIM: 1025.62 12" (N) INV. 1019.36 12" (E) INV. 1019.36 4" (NE) INV. 1024.10	CB-8, ODOT 2-3 CATCH BASIN RIM: 1026.85 12" (N) INV. 1019.36 12" (E) INV. 1019.36 4" (NE) INV. 1024.10	CB-9, ODOT 2-3 CATCH BASIN RIM: 1027.19 12" (N) INV. 1020.48 12" (E) INV. 1020.48 6" (NE) INV. 1023.00 6" (SE) INV. 1023.00	SA-1, 4" SANITARY MANHOLE RIM: 1028.01 6" (N) INV. 1023.00 6" (NE) INV. 1016.32	SA-2, 4" SANITARY MANHOLE RIM: 1017.26 6" (S) INV. 1012.10 6" (SE) INV. 1012.10
---	--	--	---	--	--	--	--	--

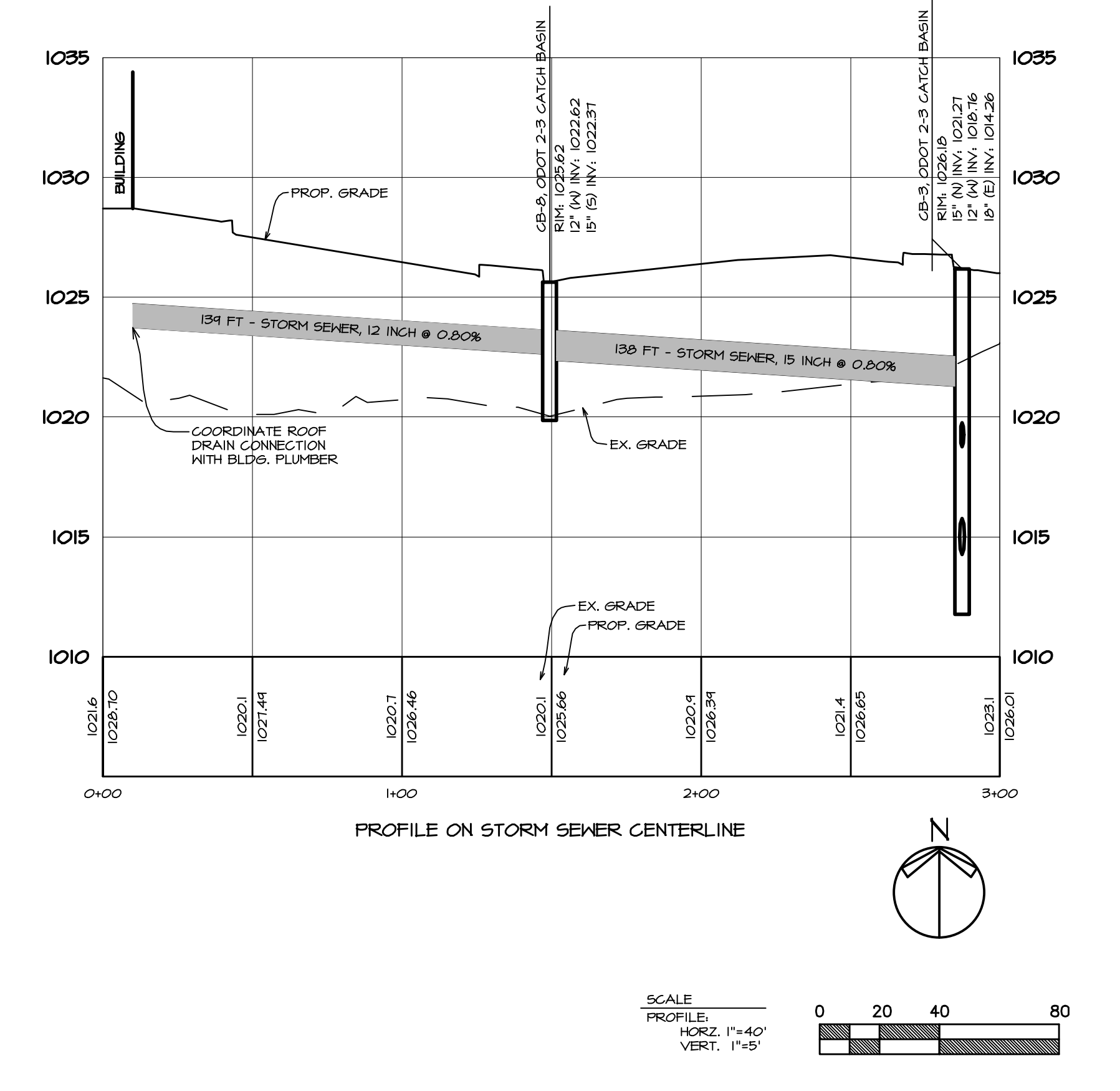
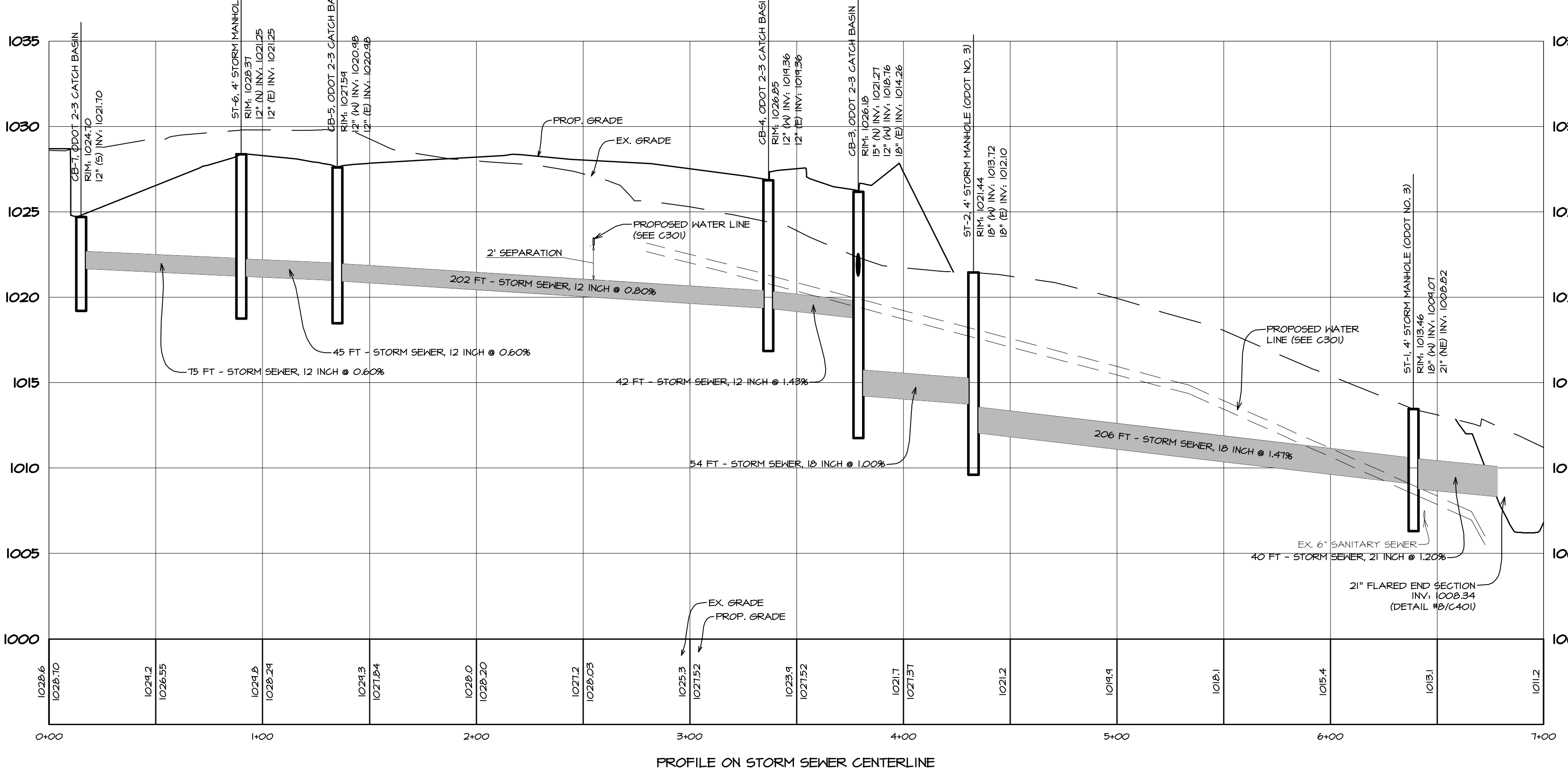

OHIO UTILITIES PROTECTION SERVICE
TWO WORKING DAYS BEFORE YOU DIG Call 1-800-362-2764

SCALE
PROFILE: 1"=40'
HORIZ.: 1"=40'
VERT.: 1"=5'

NOTE:
ALL UTILITIES SHOWN ARE APPROXIMATE LOCATIONS FROM FIELD DATA AND AVAILABLE INFORMATION. THEY SHOULD NOT BE INTERPRETED AS EXACT LOCATIONS NOR SHOULD THEY BE ASSUMED TO BE THE ONLY UTILITIES IN THE AREA.

ARCHITECTS • CIVIL ENGINEERS

paradigm design

550 3 MILE N.W.
SUITE B
GRAND RAPIDS, MI 49544

PHONE (616) 785-5656
FAX (616) 785-5657
WEB PARADIGMAE.COM

PROJECT

GFS MARKETPLACE

TEMP 120 ROTHROCK ROAD
AKRON, OH

BILL M. MADLOCK, P.E.
OH - REGISTRATION #E-64742
EXP. DATE 1/23/2012

COPLY TOWNSHIP

BLDG OWNER:
GFS MARKETPLACE REALTY FIVE, LLC
P.O. BOX 1812
GRAND RAPIDS, MI

RELEASE DATE

2-6-12	IMPROVEMENT PLAN REVIEW
4-3-12	REV. PER IMPROVEMENT PLAN COMMENT
4-23-12	OWNER REVIEW
4-27-12	FOR PERMITS & CONSTRUCTION
5-21-12	FOR PERMITS, BIDS & CONSTRUCTION
5-29-12	ADDENDUM #1
8-15-12	BULLETIN #1

PROJECT
1105054

SHEET
C303